

ISOLATED-POWER-INJECTOR

- Burst protection according to 61000-4-4
- Surge protection according to 61000-4-5

Digital interface	EtherCAT
EtherCAT connectors	RJ45
Power connectors	Wire terminal, 2 mm jack
Earth connector	Wire terminal
Wire terminal connector type	MC 1,5/ 3-STF-3.81
Power consumption	< 500 mW
Supply voltage	12-48 V
Operating temperature	-20 ... 60 degC
IP rating	IP20
Weight	105 g
Housing material	Aluminium



Recommended power supply
Mean Well SDR-75-48

PC / controller

CAT6 cable (signal only)

IOLITE-PWIN (passive PoE injector)

12-48 V DC power supply

Earth

EtherCAT IN port

EtherCAT OUT port

CAT6 cable (signal + power)

IOLITEd-REPEATER

IOLITEd-REPEATER is an EtherCAT repeater node. It is used to increase the cable length between two IOLITEd measurement devices for a lower cost than adding an additional measurement device. The REPEATER fits perfectly into the EtherCAT chain, daisy chaining the signal and power from the previous to the next device.

General specifications of the IOLITEd-REPEATER device:

Digital interface	EtherCAT
EtherCAT connectors	RJ45
Power consumption	1200 mW
Supply voltage	12-48 V
Operating temperature	-20 ... 60 degC
IP rating	IP20
Weight	105 g
Housing material	Aluminium



The schematic below shows the role of a IOLITEd-REPEATER in an EtherCAT chain.

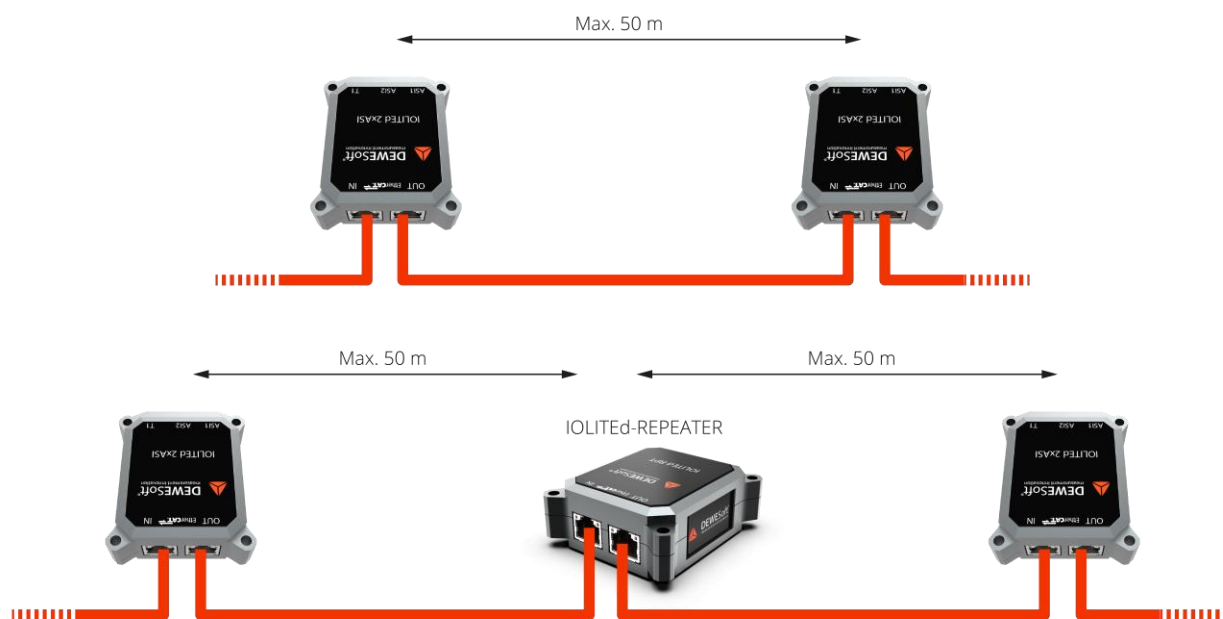

IOLITEdw waterproof enclosure

IOLITEd devices can be supplied in a waterproof aluminium enclosure with cable glands. The enclosure is designed to be mounted outdoor. Cables are to be inserted through the cable glands at the installation location and crimped to the cable connectors inside the enclosure. The top lid is to be fixed to the enclosure using an O-ring seal and four bolts after the connectors are mated.



The outdoor enclosure automatically vents air to equalize pressure inside the enclosure to the outside air pressure while it does not allow water to pass into the enclosure. This prolongs the life span of the seal and increases durability of the enclosure.

To order the IOLITEd devices inside the waterproof enclosure, ask Dewesoft Support about the -W option for your specific device.

Mechanical drawing - IOLITEd standard height housing

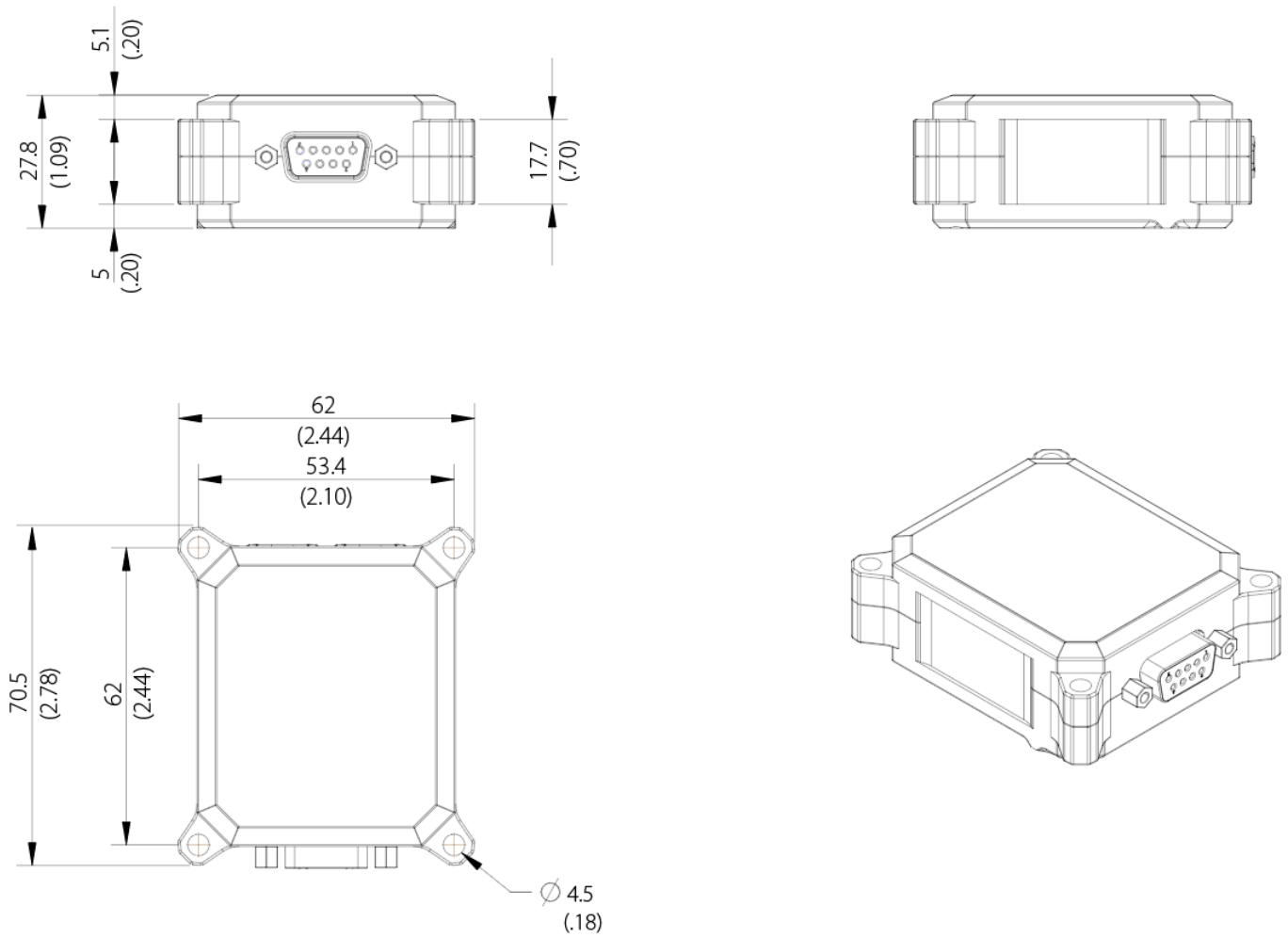

(Not to scale)

Preferred mounting: M4 screws in each of the four $\varnothing 4.5$ mm corner holes.

Mechanical drawing - IOLITEd waterproof housing

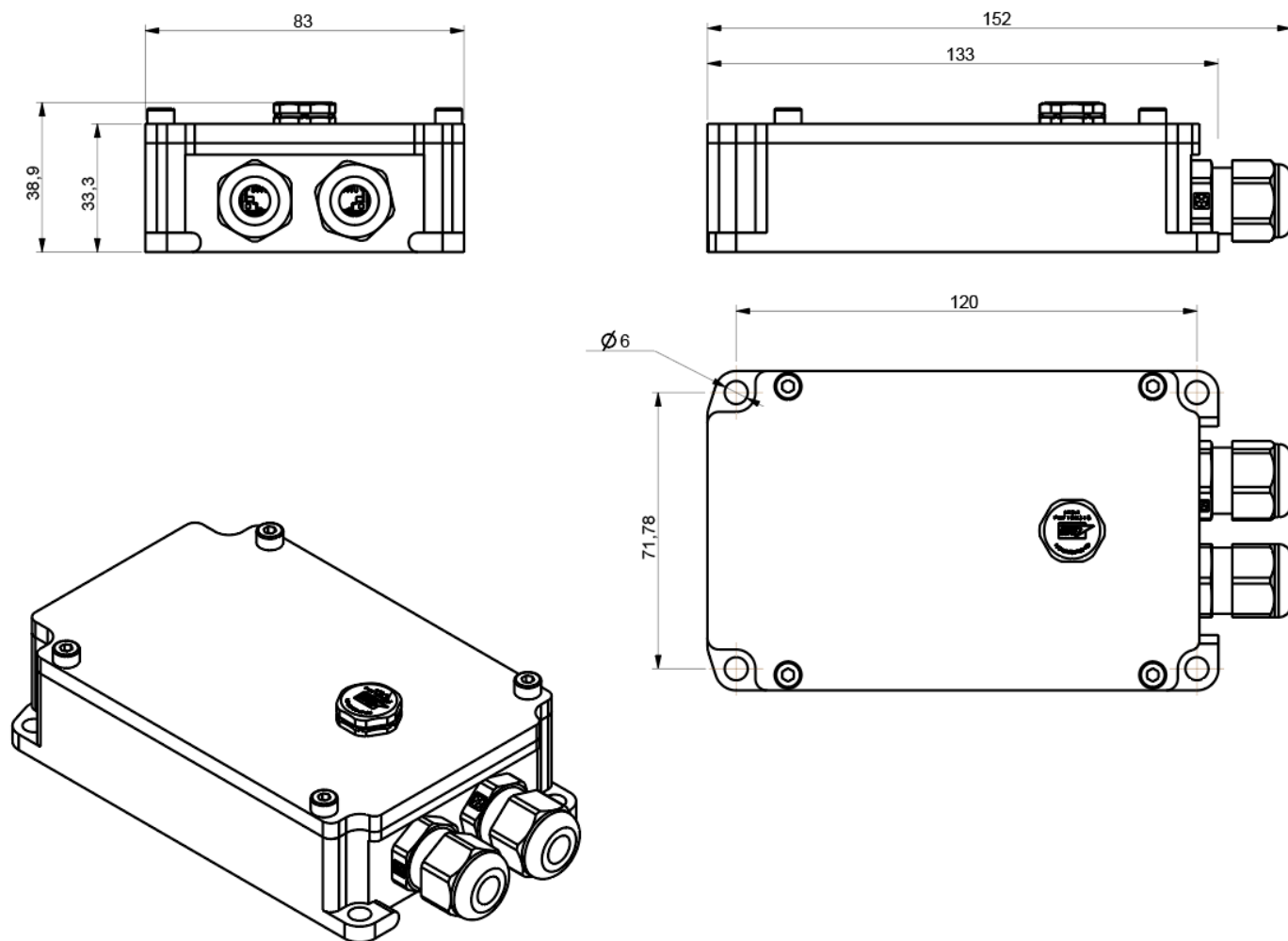

(Not to scale)

Product Warranty Statement

DEWESOFT d.o.o. (DEWESOFT) warrants its products to be free of defects in materials and workmanship, under normal use and service for a period of 24 months from date of purchase. If the unit should malfunction, it must be returned to the factory for evaluation, freight prepaid. Upon examination by DEWESOFT, if the unit is found to be defective, it will be repaired or replaced at no charge. However, the WARRANTY is VOID if the unit shows evidence of having been tampered with or shows evidence of being damaged as a result of excessive corrosion or current, heat, moisture or vibration, improper specification, misapplication, misuse or other operating conditions outside of DEWESOFT's control. Components which wear, or which are damaged by misuse, are not warranted.

DEWESOFT manufactures scientific instruments whose misuse is potentially dangerous. The instruments are intended to be installed and used only by qualified personnel. There are no warranties except as stated herein. There are no other warranties, expressed or implied, including but not limited to the implied warranties of merchantability and of fitness for a particular purpose. DEWESOFT is not responsible for any damages or losses caused to other equipment, whether direct, indirect, incidental, special or consequential, which the purchaser may experience as a result of the installation or use of the product. The buyer's sole remedy for any breach of this agreement by DEWESOFT or any breach of any warranty by DEWESOFT shall not exceed the purchase price paid by the purchaser to DEWESOFT for the unit or units, or equipment directly affected by such breach. Under no circumstances will DEWESOFT reimburse the claimant for loss incurred in removing and/or reinstalling equipment.

Every precaution for accuracy has been taken in the preparation of manuals and/or software, however, DEWESOFT neither assumes responsibility for any omissions or errors that may appear nor assumes liability for any damages or losses that result from the use of the products in accordance with the information contained in the manual or software. Interpretation and use of the measurement data obtained by DEWESOFT products is at the user's sole discretion. DEWESOFT is not in any way responsible for the analysis and conclusions drawn upon the measured data.